

LED 2.4G Wireless RF Remote Controller

Touch 2.4G Wireless RF Remote Control

433Mhz RF Frequency

Sensitive Touch Performance

>20 Meters Remote Distance

13 Keys Touch Remote +1 Color ring+Brightness bar

Strong Wall Penetration

Different Remote Control Code

Remote is pairable to Control Unit

No Remote Control Interfering

OEM / OMD Custom Services

Lighting Programs

LOGO Printing



SPECIFICATIONS

Custom Services

Lighting Programs

Loading Power

Logo on Package/Device

Input Voltage	DC5-24V (Same as LED Working Voltage)
Max Input Current	30A
Output Signal	Constant Voltage, PWM Signal
Max Output Current	18A/CH
Control Unit Material	ABS Plastic
PCB Material	FR4 Double-size Board
Working Temperature	-25℃--60℃
Storage Temperature	-45℃--85℃

RF Remote Frequency	433MHZ/wifi2.4G
Remote Power	AAA Batteries 2PCS
Remote Material	ABS Plastic

Unit Pack	G.Weight: 0.06kg9.2*5.2*3CM
Gross Weight /Carton	7KG1Packs
CBM /Carton	42*29*30CM

Lighting Programs

SN	Mode	Remark	SN	Mode	Remark
1	Static red	Brightness Adjustable (Can increase cold white light)	13	Red、 blue breath	Speed Adjustable (Can increase cold white light)
2	Static green		14	Green、 blue breath	
3	Static blue		15	3 color gradient	
4	Static yellow		16	All color gradient	
5	Static purple		17	Warm white breath	Speed Adjustable
6	Static cyan		18	Cold white breath	
7	Static white	Speed Adjustable (Can increase cold white)	19	Cold、 warm white breath	
8	3 color jump		20	Cold、 warm white、 RGB gradient	
9	7 color jump		21	Cold、 warm white、 RGB breath	
10	3 color breath		22	5 color jump	
11	7color breath		23	5 color gradient	

Dimensions



Wiring Diagrams

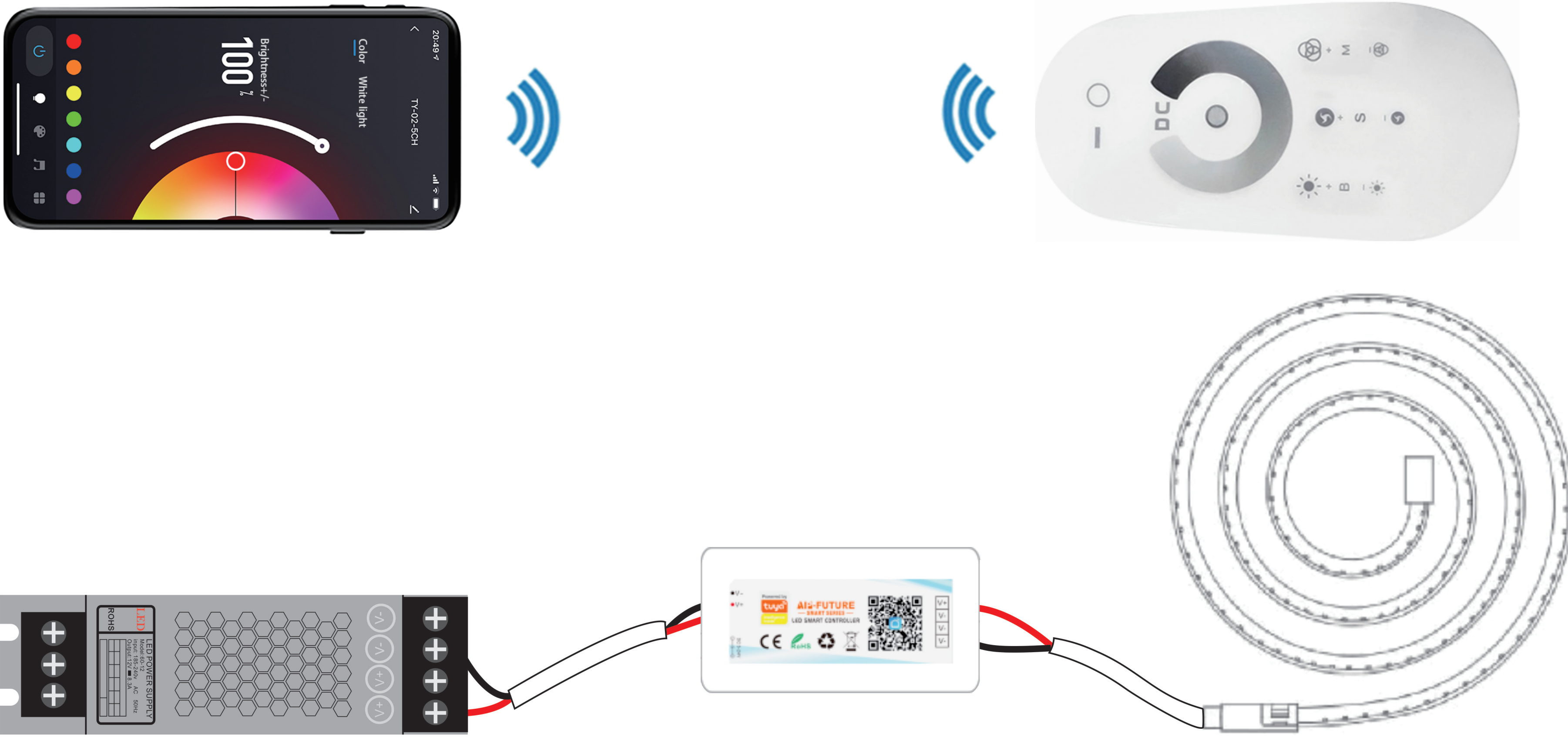

Remote Functions

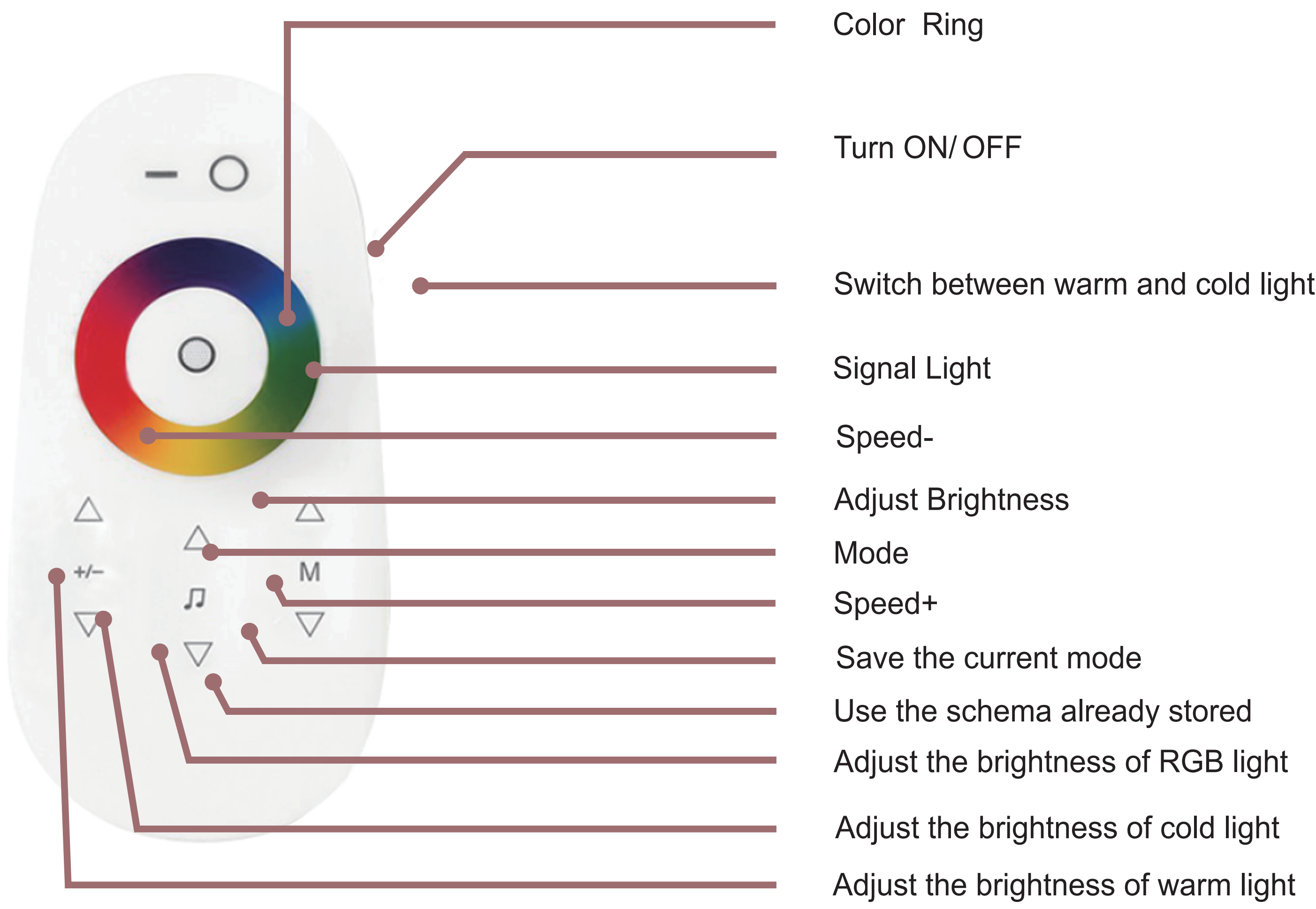

Remote Functions



Pair the Remote to Control Unit

When 2 Remote Controllers are close,there may be interfering between each other.



To avoid interfering, please pair the Remote to Control Unit

1)In 5 Seconds after Applying Power on the Control Unit

2)Press the 2 Buttons till the LED gets Flashing

If not successful. please re-do step 1) and 2)

OPERATING PROCESS

Real Product Picture



Product details

Product details



Product details



Gift packaging



OPERATING PROCESS

1, With Screw Drive, connect the 12V(or 24V)Mono LED onto the Control Unit

2, Load the Battery AAA 2PCS to the Remote

3, Power OFF the Power Supply.And connect it to the Control Unit.

Make sure the Power Supply OUTPUT Voltage,is same as the Operating Voltage of Mono LED.

DO NOT Connect the AC110/220V Pow.

4, Power ON the Power Supply.

Turn ON the Control Unit by Remote.

5, Turn OFF the Control Unit by Remote.

6, Power OFF the Power Supply.Dis-connect the Power to the Control Unit.

ATTENTION

1, The Device is NOT waterproof. Please keep it away from water

For Outdoor Application,please put the Device into waterproof junction Box

2, It is DC12/24V Device, please DO NOT connect it directly to AC110V/220V

3, Keep the Device away from the Strong Magnetic Field

4, DO NOT over load the power. The over-loading will burn the Device.