

MESH

R-103+C-103A

RGB LED MESH Grouped controller set

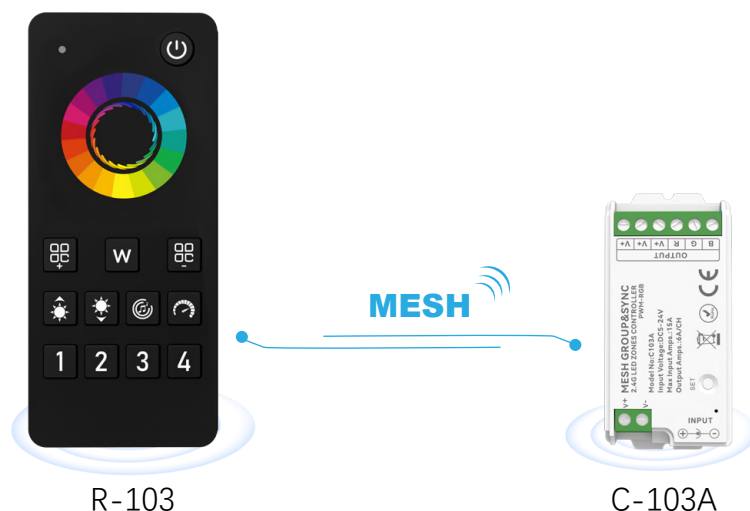

CE RoHS

MESH LED controller is our newly developed LED controller series. Can be used with a MESH remote control. The controller has the functions of automatic transmission and automatic synchronization, and the controller adopts the widely used MESH wireless technology, which has the characteristics of low power consumption, stable signal transmission and strong anti-interference.

A compatible remote control can control multiple controllers at the same time. It is widely used in the control of hotel lighting and home lighting.

The device can be divided into 4 independent zones or groups, and partition control can be realized through a single remote control, which is suitable for multi-room or multi-scenario management. A single remote control can manage and synchronize up to 500 controllers, and each controller can be supported by 10 remote controls. For example, the living room, bedroom, kitchen, and corridor can be divided into different areas, which can be switched on and off independently

Peculiarity

- MESH wireless transmission technology, stable signal and strong penetration.
- It supports matching multiple devices, and can control multiple devices at the same time, and one remote control can manage and synchronize up to 500 controllers. (Control distance 30 meters)
- The mode, color, and brightness can all be adjusted according to personal preference, and the color and speed of the dynamic mode can be edited.
- PWM (Pulse Width Modulation) technology ensures smooth light transitions to avoid eye fatigue.
- The device has an automatic transfer and synchronization function.
- It supports multi-controller cascade and easily covers large-area lighting scenarios such as shopping malls, theaters, and building facades.

Device parameters

LED controllers

| | |
|----------------------|---------------|
| Input voltage | DC 5-24V |
| Input current | 6/CH; 15A max |
| Access signal | MESH |
| Control the distance | 30M |
| Size | L75XW36XH17mm |
| Authentication | CE,ROHS |

Environment

| | |
|---------------------------------|-------------------|
| Operating temperature | Ta: -20°C ~ +60°C |
| Maximum temperature of the case | Tc: +65°C |
| IP rating | IP20 |

Wrap

| | |
|--------------------|-------------------------|
| Package size | L7.6XW3.7XH2.1cm/0.04kg |
| Box size (100 pcs) | L19XW16XH12cm/4.2kg |

LED remote control

| | |
|---------------------------|---------------------------|
| Voltage | 3V(AAA*2PCS) |
| Operating current | 10mW |
| Transmission frequency | MESH (2.4GHz) |
| Standby power consumption | 15μA |
| Transmit power | 6dBm |
| Dimming range | 1-100% Infinitely dimming |
| Remote control distance | 30M |
| Size | L122XW53XH21mm |
| Operating temperature | Ta: -20°C ~ +60°C |
| Authentication | CE,ROHS |

Wrap

| | |
|--------------------|-------------------------|
| Package size | L13XW5.8XH2.7cm/0.105kg |
| Box size (100 pcs) | L27XW30XH15cm/11kg |

Equipment mechanism and installation

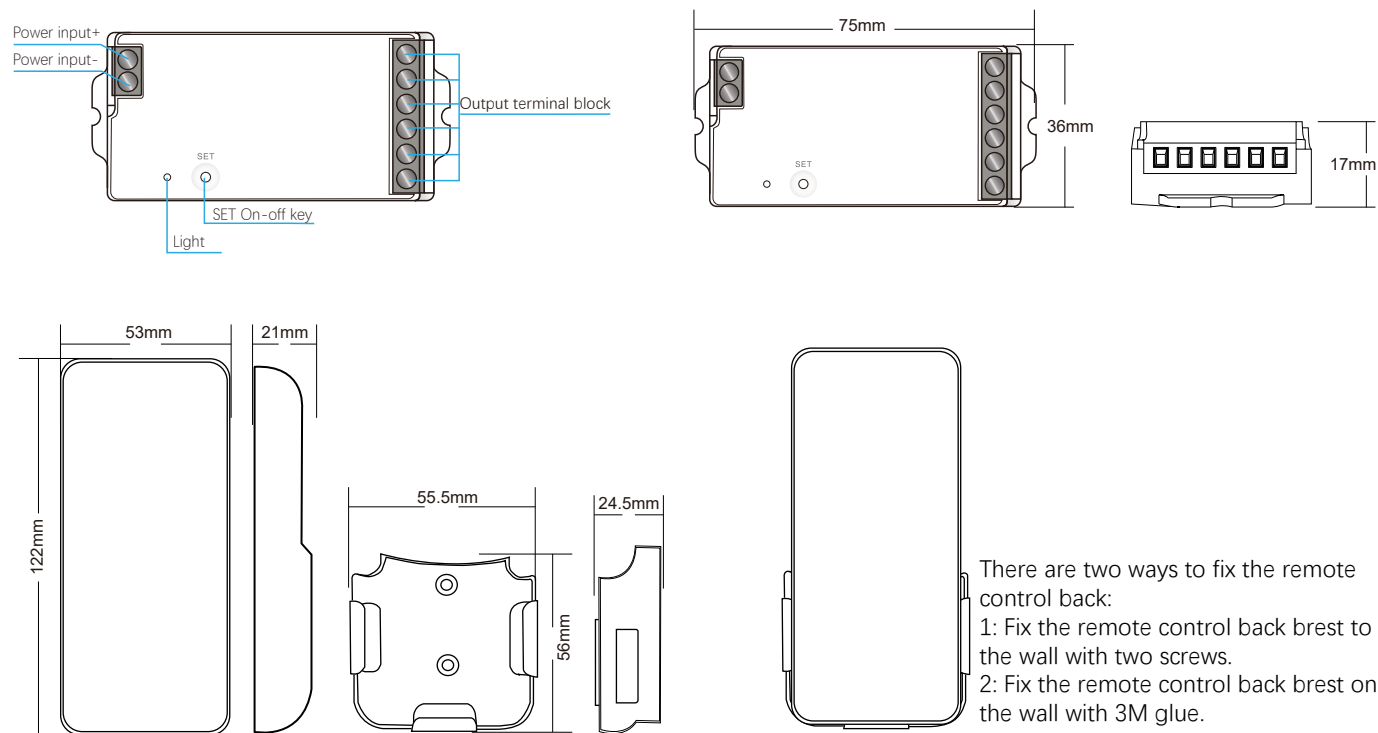

Wiring diagram of the device

Connect the strip light

AC100-240V

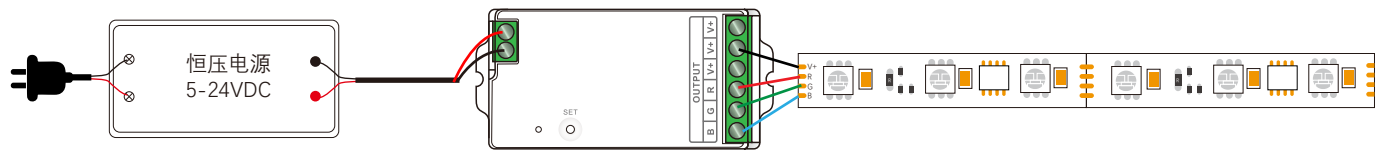

Description of the function of the remote control



R-103Remote Control Mode Comparison Table

Dynamic Mode Comparison Table

| S/N | MODE | S/N | MODE | S/N | MODE |
|-----|-------------------|-----|--------------|-----|-------------|
| 1 | Seven colors jump | 2 | Red flash | 3 | Green flash |
| 4 | Blue flashes | 5 | Yellow flash | 6 | Cyan Flash |

| S/N | MODE | S/N | MODE | S/N | MODE |
|-----|----------------------|-----|------------------------|-----|--|
| 7 | Purple flash | 8 | White light flashed | 9 | Three-color jump |
| 10 | Three-color strobe | 11 | Seven colors alternate | 12 | The three colors flickered and flickered |
| 13 | Seven-color gradient | | | | |



Note: The brightness is adjustable and the speed is adjustable

Music Mode Comparison Table

| S/N | MODE | S/N | MODE | S/N | MODE |
|-----|---------------------------------------|-----|-------------------------------------|-----|-----------------------------|
| 1 | Colorful beats to the music | 2 | Colorful gradients follow the music | 3 | Colorful dance to the music |
| 4 | Colorful flashes along with the music | | | | |

Note: The brightness and speed are not adjustable in music mode

Device code matching & cancellation

| function | | Button mode | Power-off mode |
|---|---------------------|---|---|
|  | 'SET'key | ON/OFF | Short press (release within 1s) |
|  | MESH Remote Control | The remote control is paired | Press (3S) The indicator light flashes quickly |
|  | Clean up and reset | Press and hold (10S) to The controller indicator flashes quickly | 10 Times |



Schematic diagram of the control connection



RGB MESH Grouping remote controls

RGB LED MESH Grouping controllers

Safety Precautions

1. The remote control is a precision electronic product, please do not use it in a humid or high temperature environment for a long time. If not in use for a long time, remove the battery and store it in a cool, dry place.
2. Do not use this device in a large area of metal or in an environment with strong electromagnetic waves nearby, otherwise it will seriously affect the control distance
3. Please check whether the input voltage of the constant voltage power supply meets the requirements of the controller, and check whether the connection of the cathode and anode is correct.
4. The working voltage is DC 5~24V, if the voltage is higher than 24V, the controller will be damaged.
5. Non-professional users cannot directly disassemble the controller, otherwise it may cause fire and electric shock.
6. The working temperature (Ta) is -20~60°C; Do not use the appliance in direct sunlight, humidity, or other high-temperature areas.
7. When the equipment load reaches 15A, the wire diameter must be more than 1.5 square millimeters
8. When the device load exceeds 10A, the connection cable from the DC port to the LED strip must be shorter than 40cm.
9. Please install the device in a good heat dissipation area.