

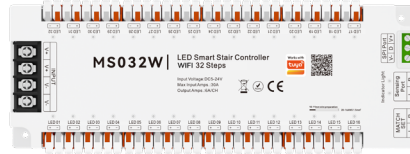

MS032B/BLUETOOTH



MS032W/WIFI



MS032Z/ZIGBEE

TUYA smart stair light is an intelligent lighting product specially designed for stair scenes, which has the characteristics of convenient control, scene adaptation and energy-saving and durable.

It supports Tuya smart APP voice assistants (such as Alexa, Google Assistant) and wireless remote control multi-mode control. Some models are equipped with human body infrared sensing function, which can realize the lights on and off without manual operation; in terms of lighting, it supports brightness adjustment of 1%-100%, and with symphony lights, it can also customize the color light effect, which is suitable for different needs such as daily communication and atmosphere creation. The product adopts energy-saving LED light source, the service life can reach more than 50,000 hours, and the output is DC5V/24V safe voltage. During installation, some kits include quick connectors. The light strips can be cut as needed to adapt to indoor stairs such as villas and duplex buildings. With waterproof light strips, they can also be used for outdoor stairs or corridors, taking into account practicality and scene flexibility.

Equipment parameters

LED controller(MS032)

Input voltage	DC 5-24V
Input current	6/CH; 最大30A
Access signal	MESH(2.4G)+WIFI/ZIGBEE/BLURTOOTH
Output type	PWM + SPI(TTL)
Size	L23XW8.7XH2CM
Certification	CE,ROHS

environment

Operating temperature	Ta:-20°C~+60°C
-----------------------	----------------

Maximum shell temperature	Tc:+65°C
IP rating	IP20

Induction data

Sensing range	3M
Sensing angle	180°

packaging

Package size	L260XW110XH60mm
Remote control distance	30M

Equipment mechanism and installation

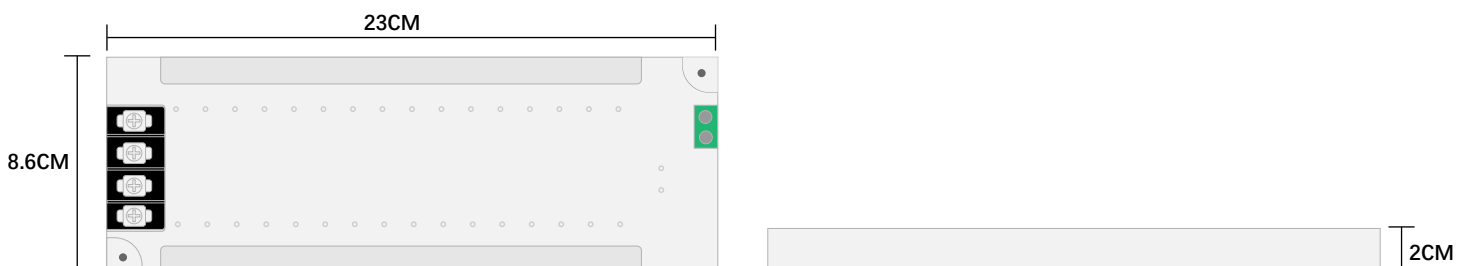
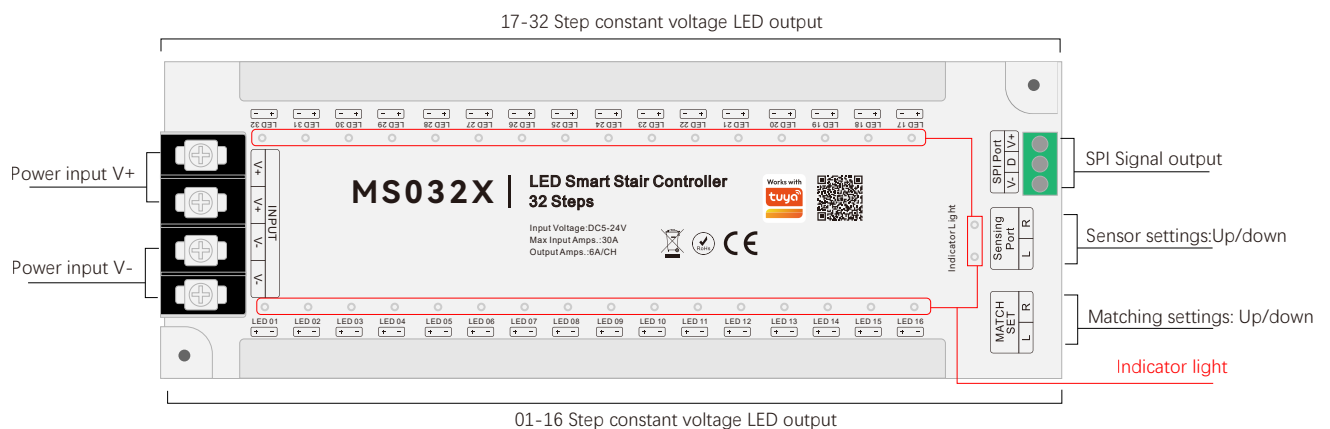

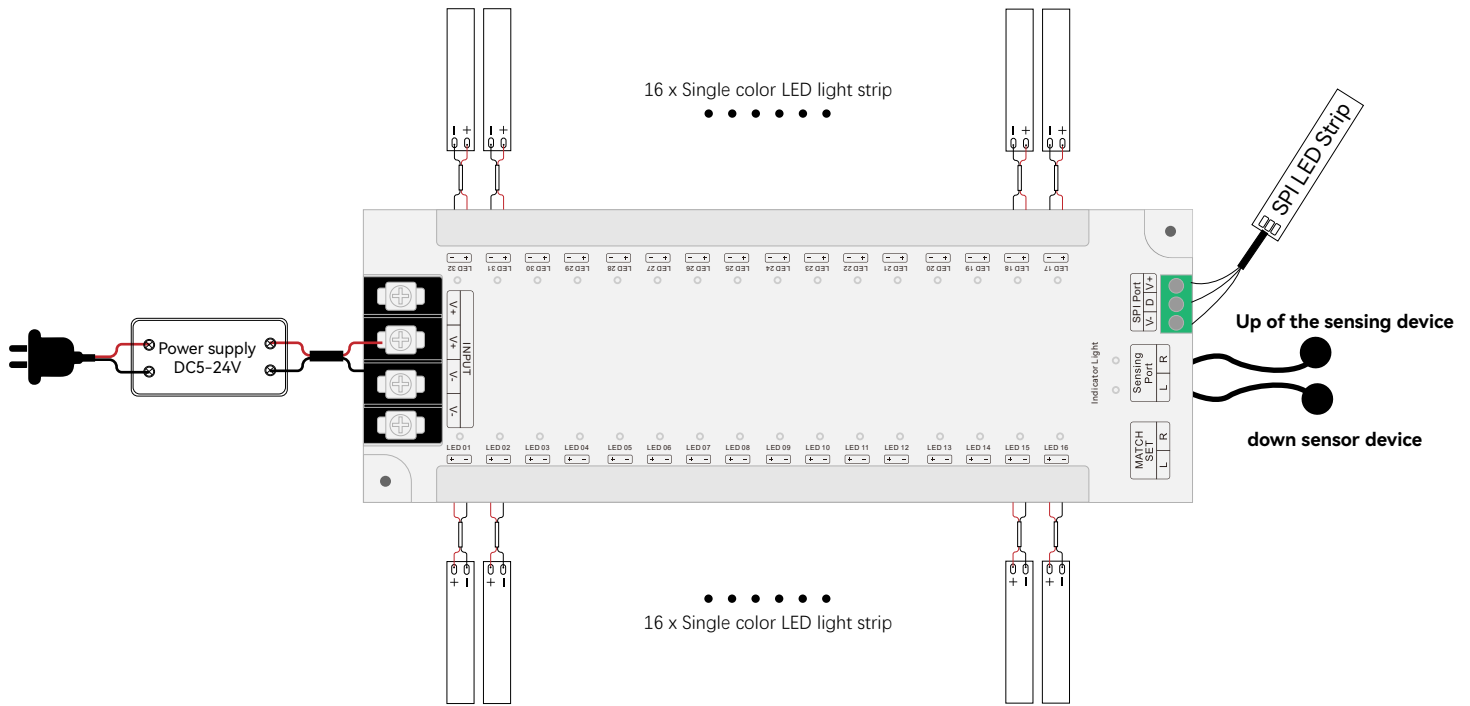

Controller instructions for use

Download the APP

Search for **[Tuya Smart]** in Apple or Google store or scan following QR code to download and install the app. Please click " Register " button to create account while using it in the first time, Log in directly if you already had account.



Product function description&Reset Devices



Matching settings:
Press 'R' to pair, the stair light will light up from top to bottom

Press 'L' to pair, the stair light will light up from the bottom to the top

1. Wireless sensor pairing (R/L channel distinction)

- ① Pairing R channel: Press and hold the R key for 3 seconds; pairing L channel: press and hold the L key for 3 seconds;
- ② After the indicator light flashes quickly, let go and press the sensor pairing button to complete the pairing

2. Mobile APP distribution network

- ① Press and hold any one of the R/L keys for 5 seconds;
- ② Let go when the indicator light flashes slowly, the device enters the distribution network state, and press the APP prompt to operate.

3. Equipment reset (factory reset)

- ① Press and hold any one of the R/L keys for 10 seconds;
- ② After the indicator light is completely off, let go, the device clears the WiFi and sensor matching data, and returns to its initial state.

Link to Smartphone

MS032W-WIFI Connect to the tuya APP

- (1) . Make sure Smartphone is working on WLAN network.
- (2) . Open the login APP, press and hold to discover the device, if it is not found, click "+" in the upper right corner and then manually select "Add new device," (when adding, you need to enter the WIFI password of the smartphone connection, And wait for the connection to complete after successful input)Follow the steps to complete the connection:

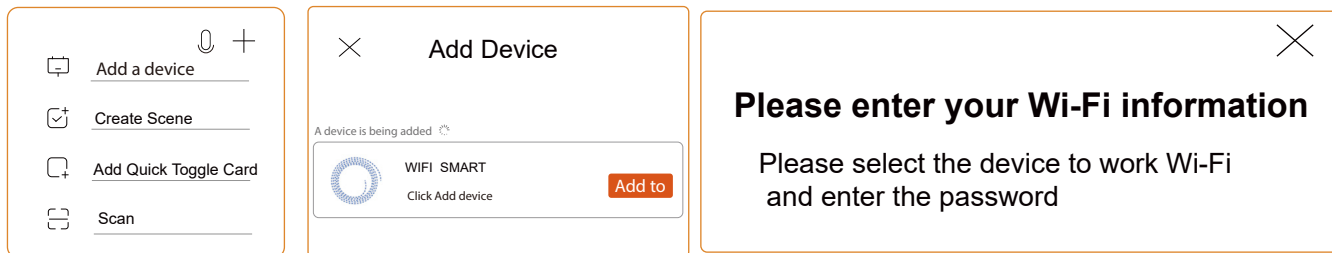

- (3) . After the connection is successful, the new device will be displayed on the home page, then tap the device and enter the control interface to do more.

MS032B/BLUETOOTH Connect to the tuya APP

- (1) . Make sure Smartphone is working on WLAN network.
- (2) . Open the login APP, press and hold to discover the device, if it is not found, pleaseclick "+" in the upper right corner, and then manually select "Add New Device", Wait for the connection to complete.Follow these steps to complete the connection:

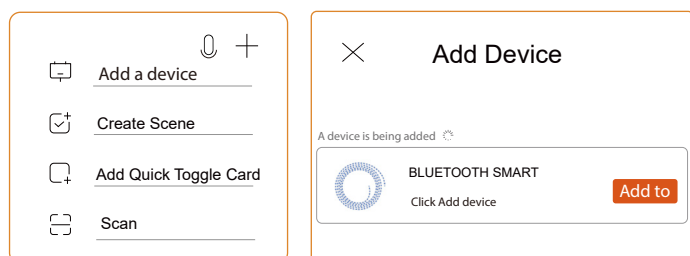

- (3) . After the connection is successful, the new device will be displayed on the home page, then tap the device and enter the control interface to do more.

MS032Z-ZIGBEE connects to the Tuya APP (requires a Zigbee gateway)

- (1) . Make sure Smartphone is working on WLAN network.
- (2) . Open the Tuya APP, select Manually Add Gateway Central Control, select Zigbee Gateway, and enter the WIFI password to connect (Incorrect WIFI password will cause the connection to fail, non-2.4G network WIFI also.)will cause the connection to fail
- (3) . Reset the Zigbee gateway device, the red and blue lights of the Zigbee gateway are always on, turn on the power supply, please confirm that the red light is flashing, the blue light is always on, and the red light is always on after the connection is successful.
- (4) . Click Done to enter the gateway control interface, add sub-devices, and confirm that the sub-devices belong to the network configuration mode (please place the gateway, controller, and smartphone close to each other for quick speed.)Pairing identification) long press the controller'R'/L' for 5 seconds, after the connection is successful, the sub-device will be displayed on the home page, then tap the device and enter the control interface to do more.
- (5) . After the controller is installed in the APP, we can easily control the LED lighting with the APP.

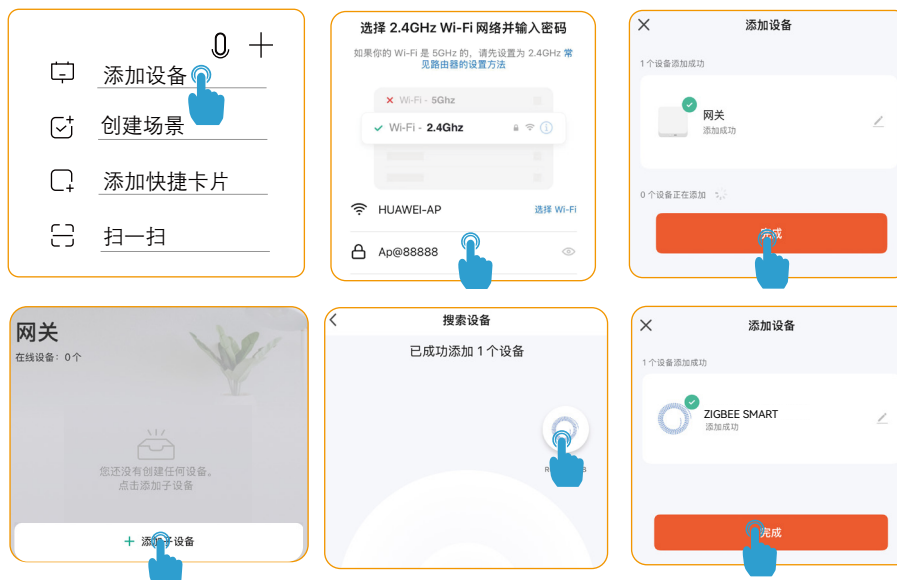

APP interface

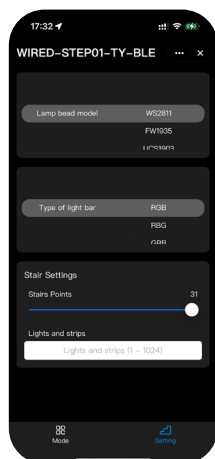

Setting

Can drive 6 types of IC digital RGB LED strips, can set the IC type and R/G/B order. Compatible ICs: WS2811, FW14935, UCS1903, TM1812, SK6812, WS2814.

The number of stair steps can be set from 1 to 32.

The number of LED strip lights can be set from 1 to 1024.

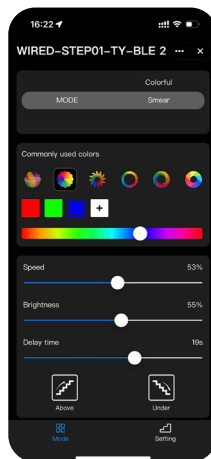

Mode

Six color-changing modes can be set: flowing, alternating, all on, following, rainbow, and trailing.

Multiple colorful lighting options can be set

Speed:1-100%

Brightness:1-100%

Delay time: 1-32s

Lighting Test:

Up - The staircase lights will turn on from top to bottom

Down - The staircase lights will turn on from bottom to top

Setting: Select the lamp bead model, lamp bar type, step setting, etc. on this page.

Mode: You can choose the mode of lighting, control the color, speed, brightness of the lighting, delay the lighting, and test the lighting...

Compatible remote control collocation



Pair the stairway light controller 'R' channel. When it detects a person, the stairway lights will light up from top to bottom.

Pair the staircase light controller 'L' channel. When a person is detected, the staircase lights will turn on from bottom to top.

MR501-Human body sensor



Pair the staircase light controller 'L' channel. When a person is detected, the staircase lights will turn on from bottom to top.

Pair the staircase light controller 'L' channel. Press the switch and the staircase lights will turn on from bottom to top.

MR021/1 Way-Wall panel switch

Packing List



controller*1



Wire identification sticker*1



Manual*1



sensor*2
Surface-mounted sensor base *2
Screws *2

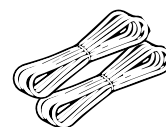

Extension cord 5M*2
(Can be extended up to 200 M)

Precautions

Surface-Mounted Sensor Probe

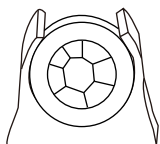

Recessed sensor probe opening size

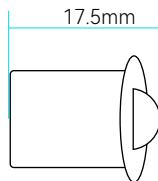
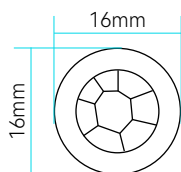

Sensor probe installation location

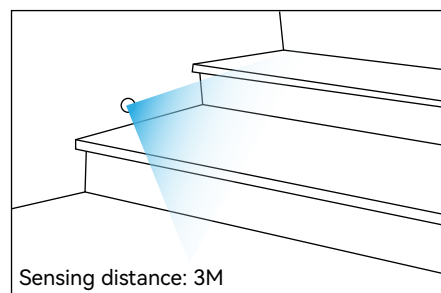

Precautions

1. The sensor probe should be installed in a dry environment, and avoid exposure to wind and rain.
2. Pay attention to the installation direction and angle during installation.
3. There should be no obstructions within the sensing range.
5. Do not immerse in water or use near a water source.